



Gen 2 Polaris Slingshot Short Shifter (2020+) DDM-14-17



This short throw shifter kit for the Polaris Slingshot reduces the amount of forward and side to side movement that is required to shift the transmission into gears.

If you are pretty handy with tools the shifter can be installed in 30 minutes, however we suggest that you schedule at least a couple of hours for the installation.

If you have any questions during the installation you can call or text (864) 907-6004. Email support is also available - Tech@ddmworks.com.

Tools Needed for Install

- 5mm Allen Key
- 10mm socket
- Socket extension
- All purpose grease
- Paper Towels
- Ratchet driver for sockets

DDMWorks - 119A Hwy 183
Piedmont, SC 29673
Tech Support Call, Text or Email:
(864) 907-6004,



Installation of Short Shifter

1. To install the short shifter, the first thing is to lift up on the body colored surround around the shifter. Start by getting your fingers under the corner on the drivers side, there are a couple of tabs holding it in, as you pull up, they will pop and release.
2. With the body colored part around the shifter popped up, the next part to get free is the black textured plastic around the shifter itself. There are 2 tabs at the bottom of the plastic, between the shifter and cup holders.
3. Once that textured black plastic is released and able to be lifted up, you will see the shift boot around the shifter, you can get under the edge of it and also lift that shift boot up, which will expose the metal shifter rod under the shift knob.

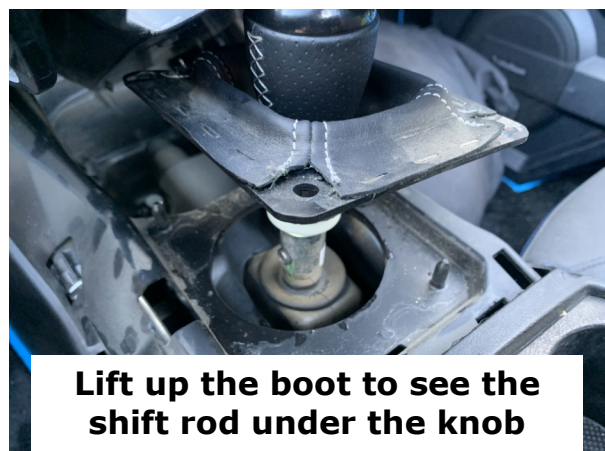

Installation of Short Shifter

4. Use a 5mm Allen key in the socket head bolt on the drivers side of the metal shift rod. It has loctite on it and may need some force to break free.
5. Once the bolt is loosened, you will be able to lift the shift knob with shift boot off the transmission and out of the way. Before removing the shift knob, make sure the transmission is in neutral.
6. With that piece removed, you will see a rubber boot cover over the transmission shifter. Simply lift up on the rubber boot to expose the metal plate with 4–10mm head bolts holding it in place. Remove all 4 bolts and the stock shift mechanism will lift out of the transmission.
7. In the new short shifter kit, you will see 2 black parts, one part is a round part that has 2 slots in the side of it. Slide that piece into the hole you just removed the stock shifter from, making sure that the slots on the side go over the 2 pins inside the transmission.

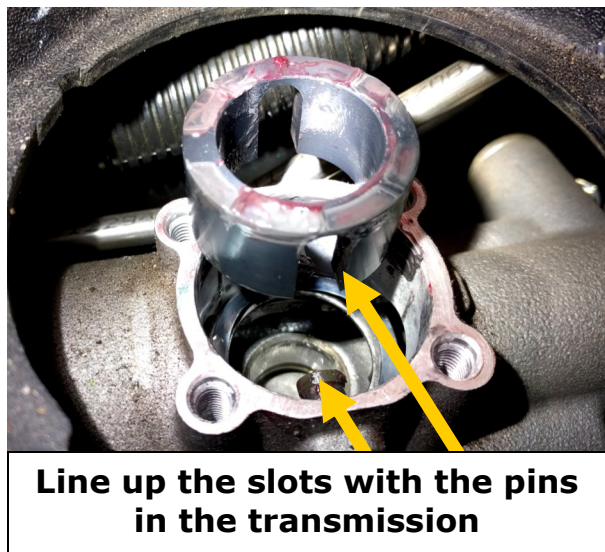
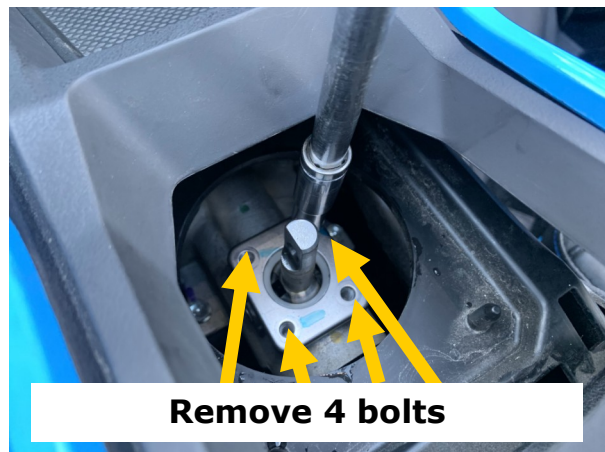

Installation of Short Shifter

8. Next step is to transfer the 2 parts from the stock shifter needed on the short shifter. The first piece to get transferred is the larger white plastic piece that fits over the ball portion. You can pop this piece up and over the ball and it will come off the stock shifter. This can usually be done with just your fingers by gently prying the open end to get it over the ball portion. Next, the smaller plastic piece on the small ball at the end of the shifter needs to come off. This one is held in place a little firmer. We have found the best way to get it off is to use a wrench and a pair of needle nose pliers like in the following picture. Be careful with this piece, when it comes off, sometimes it pops off and will go flying. Make sure it can not fall into something and get lost.
9. Now take those 2 pieces and make sure to spread grease on them, then install them on the same places on the new shifter. Make sure that the small black spring is still on the top of the white plastic piece that goes over the large ball. Also make sure that the slots in the white plastic piece line up with the slots in the shifter. Be careful when putting the small end on the shifter, there are little balls in there, make sure they do not come out when pressing it onto the new shift mechanism.

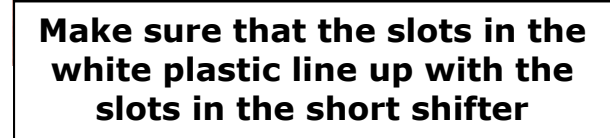
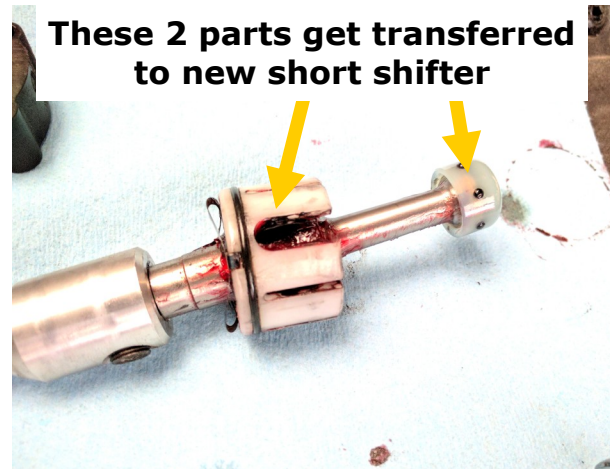

Installation of Short Shifter

10. With the new short shifter greased and ready to install, hold the white plastic around the center of the shifter and then spin the metal portion back and forth for about 30 seconds. This helps smooth out any irregularities and will make the shifter a little smoother. After doing this, make sure there is plenty of grease on the shifter around this white plastic and ball area of the new shifter mechanism.

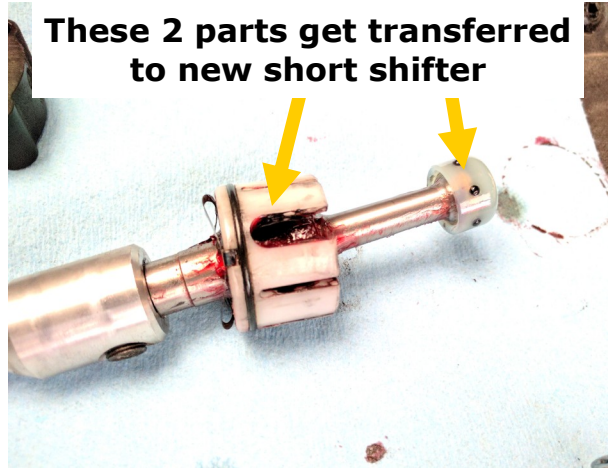

11. With the short shifter ready to install, we need to install the second black metal piece that came in the kit. It has 2 pins pressed into it. This piece will set down on top of the cavity that the shifter came out of with the **pins on the bottom**. The pins also need to be installed so that they are **facing the front and back** of the car (not side to side like the stock shifter). Roughly line up the 4 holes in this piece with the 4 holes for the bolts in the transmission below.

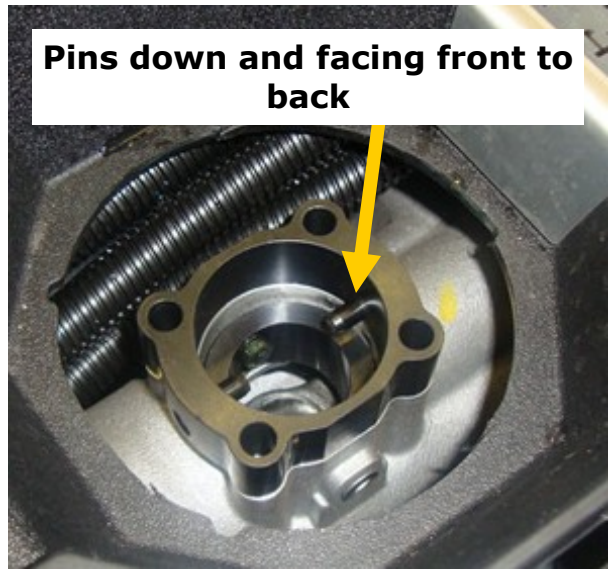

12. With the short shifter rod ready to install, you will want to make sure that the small plastic bushing at the end of the shifter is nice and level, then slowly start lowering it into the cavity that the stock shifter came out of. Since the car is in neutral, the hole that the bushing needs to go into is straight down. If you have a flashlight you can look down and see it. While lowering the shifter into position if it touches anything, the small bushing will kick to the side and not go into the transmission. It may take a couple tries, but eventually the short shifter will drop into position.



Installation of Short Shifter

13. When the new shifter is all the way down, the top of the white plastic will sit pretty flush with the piece that was just installed with the 2 pins.
14. Next find the small plate that was removed from the stock shifter and it will go on top of the shifter mechanism now. Use the new longer bolts included with the kit and tighten down the 4 bolts to secure the new shifter in place.
15. Next find the small rubber boot that was removed and place it back over the short shifter and metal plate.
16. Next place the shift knob and boot back over the metal part of the short shifter sticking up from the transmission and tighten the 5mm bolt you loosened earlier. Once the bolt is tight, then push the shift boot down and back into place, making sure to line the locating pins up to the holes in the shift boot.
17. Next lower the black textured piece down over the shift knob and boot and make sure the 2 tabs line up with the holes that they go into in the center console. Once they line up, push the piece down to lock it into place.

Install the metal plate with the 4 new bolts supplied



Install the shift boot and knob back onto the short shifter

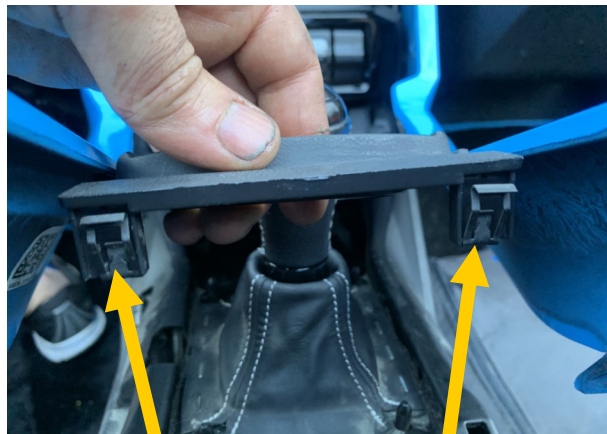

Make sure these 2 tabs are lined up with the holes they go into



Installation of Short Shifter

18. The body colored trim piece is the last part to put back in place. Lower it down into position, make sure to watch the front of the piece, close to the radio to make sure it is lined up also. Once it looks like it is in the correct position, push down on the corners where the tabs are located to secure it into place.



Congratulations!

You have finished the install. All of us here at DDMWorks thank you for your purchase and hope you enjoy your new short shifter.

If you have any questions feel free to give us a call or text us at 864-907-6004.

You can also email us at Tech@ddmworks.com.

Also, Follow us on Face book for the latest product and information releases!

