

DDMWorks



Automotive Performance Specialists

LNF Charge tube kit



This charge tube kit replaces the stock crushed tubes on your GXP/Redline with CNC mandrel bent tubes offering better looks and smoother air flow.

Installation time of the charge tubes depends on you and your mechanical skills. It is suggested that you read through the directions a few times to familiarize yourself with the components of the kit, and your car.

If you are pretty handy with tools these charge tubes can be installed in 30 minutes, however we suggest that you schedule at least a couple of

hours for the installation.

If you have any questions during the installation you can call us at (864) 907-6004 or email us at Tech@ddmworks.com.

PACKING LIST

ITEM	QTY
LNF Charge Tube- Drivers side	1
LNF Charge Tube- Passenger side	1
3in Silicone Hump Hose (2.5" Diameter)	1
6" inch Silicone Straight Hose	1
M6x20 Stainless Steel Hex	1
M6 Large Washer	1
3/8" Plastic spacer	1

TOOLS NEEDED

7mm, 10mm, & 11mm socket
Socket wrench
Adjustable wrench
Small blade screwdriver

Before Starting—Make sure to look through your tubes and make sure they are free of any packing material or debris. If any residual polishing compound is found inside the tubes, simply running soap and water through the tubes will clean them

DDMWorks



Automotive Performance Specialists

119-A Hwy 183
Piedmont, SC 29673

Tech Support
(864) 907-6004

Tech@DDMWorks.com

Rev 7-12-11 MJB

Driver side tube installation

1. The first tube that we are going to install is the drivers side. The picture to the right shows the drivers side tube in its stock configuration. The first step is to unplug the TMAP sensor. To do this squeeze the connector by the wires going into the plug and pull the connector off of the TMAP sensor.
2. Next there is a vacuum line with brass connector just to the side of the TMAP sensor that you will need to remove from the stock tube to install into the new charge tubes. Use a wrench to loosen this brass fitting out of the stock tube and set it aside.
3. Now there are 2 brackets that are holding the tube in place. Each of these brackets has a 10mm head bolt holding the tube to it. Go ahead and remove the bolts from the tubes and the brackets, also remove the front bracket from the car. There are 2 more nuts holding that bracket in place, remove those 2 bolts and remove the bracket from the car, as we will not be reusing it.
4. Now the hose clamps on the tubes need to be loosened. Use a 7mm head socket to loosen the clamp, or a blade screwdriver. Loosen the clamps completely then start to remove the tubes from the couplers. The tubes are in pretty tight and you will need to use a small blade screwdriver to help pry the tubes out. Once you get one side out of the connector, you can twist the tube to help get the other side out. Once the tube is out, we can start putting the new tube in.
5. The best way to start the new tube is by inserting it into the rubber connector closest to the engine first. Then once that side is in, insert the tube into the connector going into the intercooler. We have included a new 6" connector to replace the stock one on the driver's side as some cars require it and some do not. This connection is going to be tight, but the new intercooler tube will fit in. It is best to use a small blade screwdriver to help feed the new tube into the connector.
6. In the stock tubes there is a little clip that the bolt went into. You need to remove that clip from the old tube and slide it onto the tab on the new tube. You may need a small blade screwdriver to remove the clip from the old tube.
7. Once this clip is put into the new tube, go ahead and reuse one of the mounting bolts and secure the tube to the bracket above the radiator.
8. Tighten the hose clamps to secure the tube in place.
9. Next, insert the TMAP sensor into the tube and use the supplied bolts to tighten it down.
10. Lastly, tighten the brass fitting into the tube, it will tighten in a couple turns and secure itself in place. **Do not try to overtighten this fitting.** Now on to the passenger side.

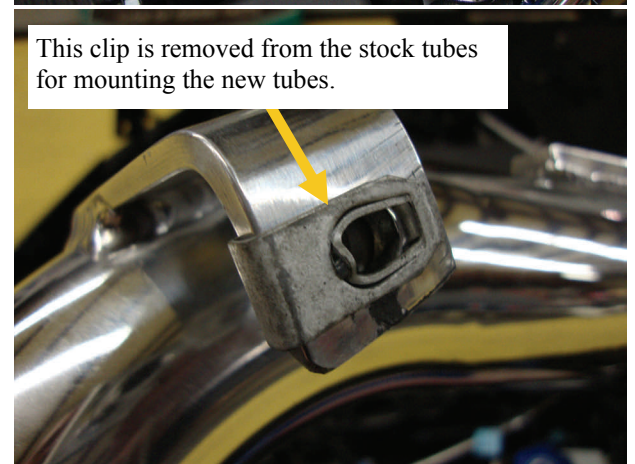
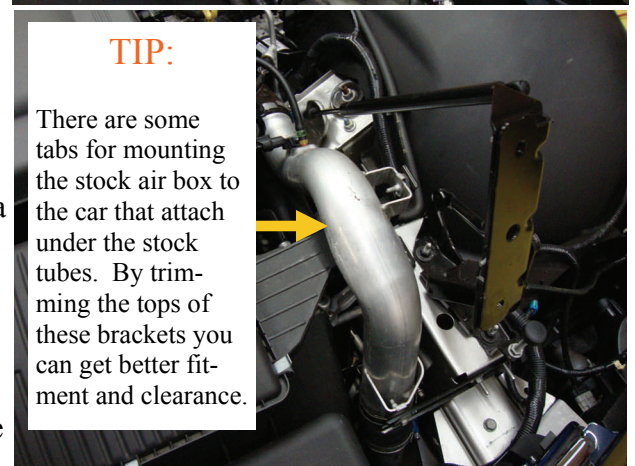
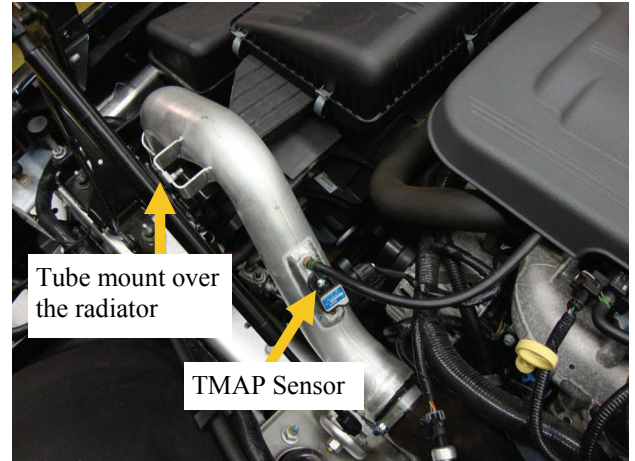

To get the front of the tube to go into the intercooler connector, use a small screwdriver to work around the tube and pop it in place.

Installing the passenger side tube

1. To install the passenger side tube, we are going to follow the same general directions as the drivers side.
2. First you will need to remove the bolts holding the tube to the brackets on the car. There is a bracket above the radiator and one towards the front of the car. The bracket on the front of the car needs to come off completely also. To do this, remove the nuts holding it on. Your stock horn should also be mounted on the passenger side of the car also. After you remove the bracket from the car, put the horn back onto the studs and use one of the nuts you removed to secure it back in place.
3. Once the tube is free of the brackets holding it in place, loosen the hose clamps. There is one at the intercooler connector and also two towards the turbo. The clamps near the turbo are a different type and require an 11mm socket. Loosen the nut on the clamps which will allow them to slide off of the rubber coupler. You will need to remove both clamps from the rubber coupler on the passenger side.
4. Now that all of the hose clamps are loose, remove the passenger side tube from the car the same way that you did with the drivers side tube.
5. You will also need to transfer the same clip that you transferred on the drivers side tube to the passenger side tube. Once again a small screwdriver will help get it out of the stock tubes.
6. Once you have this transferred, you will need to locate the small plastic spacer in the kit that was shipped to you. This spacer needs to be installed under the intercooler tube mount on the passenger side of the car that is just above the radiator. Remove the nut holding the bracket in place, put the plastic spacer over the stud and then put the bracket back on top and tighten the nut back down.
7. Now put the hose clamps you removed from the rubber connector near the turbo over the new 3" silicone coupler (Hump hose) that was included in the kit, 1 clamp on each side of the connector. Slide that new connector over the passenger side tube also.
8. Now insert the silicone connector and tube onto the turbo outlet and then feed the front of the tube into the intercooler coupler using the same technique as you did with the drivers side.
9. Once the tube is in place, use the new bolt and washer to secure the tube to the mounting bracket above the radiator.
10. Now that the tube is secure, make sure to tighten down all of the hose clamps.

*PLEASE NOTE—If using the stock intake box, some cars will require the top of the tabs on the side of the stock intake box to be trimmed down to allow the tubes to sit low enough to clear the hood.

Congratulations! You have successfully installed your new DDMWorks LNF Charge tubes!

DDMWorks

119-A Hwy 183
Piedmont, SC 29673

Automotive Performance Specialists

Tech Support
(864) 907-6004

Page 3

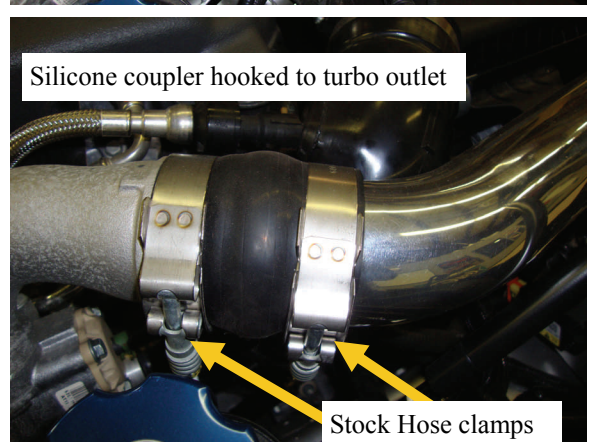
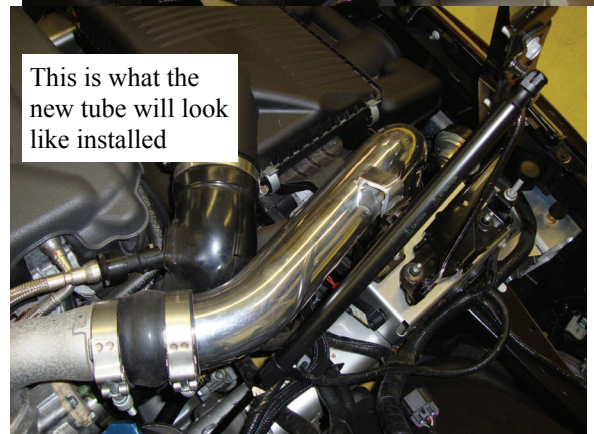
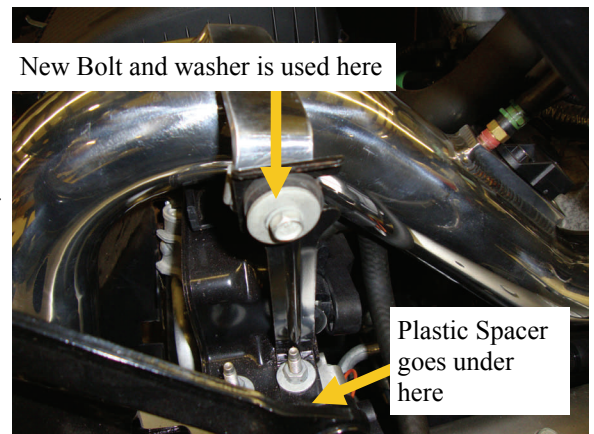

Rev 7-12-11 MJB